

Art. **1042**

INFO

PIATTO DOCCIA IN CERAMICA
Ceramic shower tray

PESO **Kg 30**
Weight

REVISIONE 1.0
Silvano Mariano

DATA
05/03/18

CE EN 14527 



COLORI

 **BIANCO LUCIDO** **cod. 1042**
Glossy White

 **BIANCO matt** **cod. 1042MT**
Matt White

 **NERO MATT** **cod. 1042NEMT**
Matt Black

 **SABBIA** **cod. 1042SA**
Sand

 **OTTANIO** **cod. 1042ON**
Blue Petrol

ACCESSORI INCLUSI

PILETTA Ø90 CON COVER IN CERAMICA
Open drain Ø90 with ceramic cover

 **cod. 9074**  **cod. 9074MT**

 **cod. 9074NEMT**

 **cod. 9074SA**

 **cod. 9074ON**

N.B.
LA FINITURA BIANCO LUCIDO VIENE TRATTATA CON PRODOTTO ANTISCIVOLO, LE FINITURE MATT HANNO PROPRIETA' ANTISCIVOLO DIRETTAMENTE NELLO SMALTO.
Glossy finish is treated with anti-slip solution, Matt finishes have anti-slip properties directly inside glaze.

VISTA DALL'ALTO

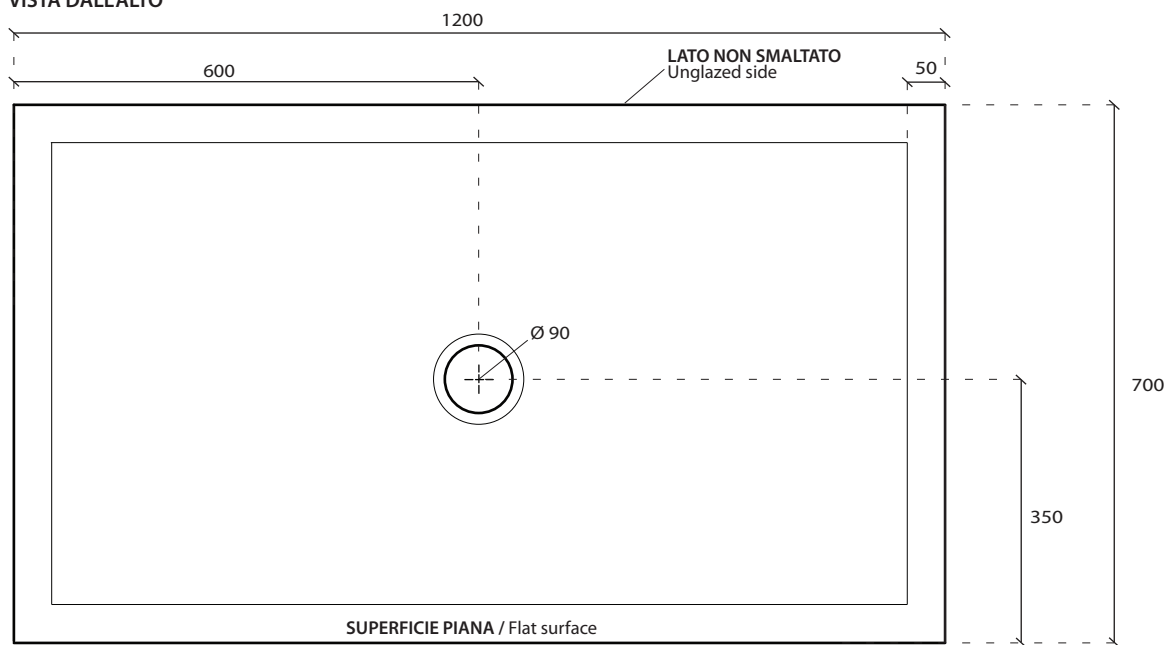

VISTA LATERALE

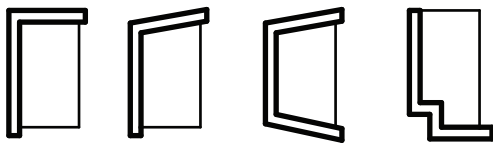
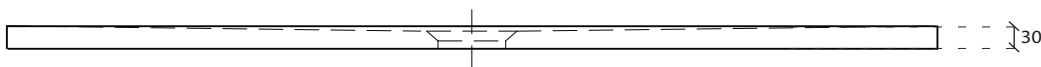

IL TAGLIO PUO' ESSERE EFFETTUATO SOLO SUI LATI IN PROSSIMITA' DELLE PARETI.
IL TAGLIO POTREBBE VARIARE LA CENTRALITA' DELLO SCARICO.
The cut must be made only on the sides that are placed against the wall.
The central position of the drain could vary after the cut.

COD. 9074

CAPACITA' DI SCARICO : 33,6 Lt/min
Flushing Volume: 33,6 Lt/min

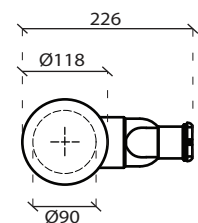

ATTENZIONE:

Galassia Spa persegue la filosofia di migliorare i prodotti aggiungendo nuovi materiali, innovazioni progettuali e tecnologie produttive. L'azienda si riserva di cambiare schede tecniche e caratteristiche di funzionamento degli articoli in ogni momento e senza necessità di preavviso. I pesi possono subire variazioni del 20%.

ATTENTION:

Galassia Spa is constantly improving its products by adding new materials, new projects and modern production technologies. The company reserves the right to change any technical specifications/ dimension and/or operating characteristics of the products at any time and without giving notice. the ceramic items weight may vary up to 20%