

# BOWL+ BIDET BPS10.BI

# GLOBO

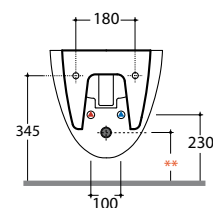
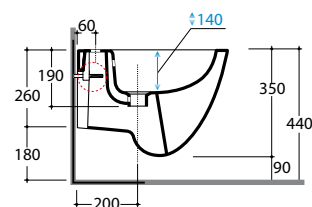
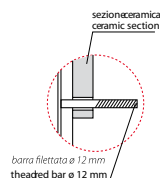
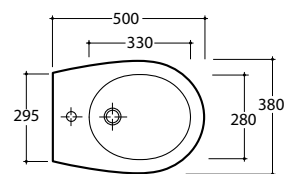

\*\* per installazione con / for installation with:  
- silicone a "S" aliphoni®: mm 170  
- silicone SF052 aliphoni SF052 mm 130

Cod. **BPS10.BI**

Bidet sospeso monoforo con sistema di fissaggio nascosto. Peso 18 kg.  
*Wall-hung bidet one hole provided with hidden fixing system. Weight 18 kg.*



Cod. **FI002**

Staffa di fissaggio a "L". Peso 2,5 kg.  
*Fixing brackets for W/H sanitary. Weight 2,5 kg.*

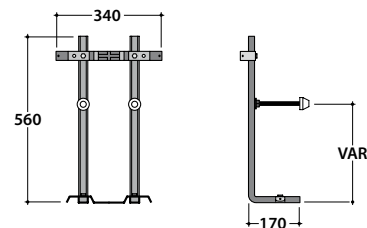

Cod. **FI002**

Protezione antiurto e acustica. Peso 0,2 kg.  
*Acoustic and crash protection. Weight 0,2 kg.*