

GRACE VASO MONOBLOCCO GR004BI

CE EN 997:2015

GLOBO

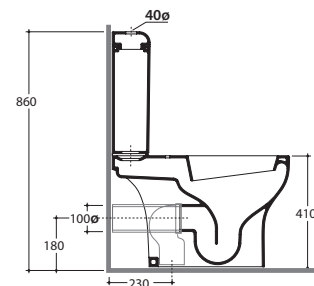
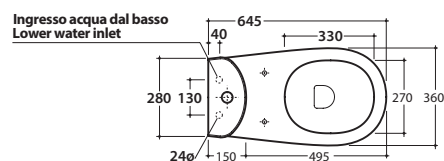

Scarico ottimizzato a 4,5/3 litri
Drain 4,5/3 lt

Cod. **GR004BI**

Vaso monoblocco 65.36 h41. Scarico 4,5 / 3 Lt. Completo di fissaggi. Peso 28 Kg
Close couple Wc 65.36 h41. Drain 4,5/3 Lt. Fixing kit included. Weight 28 Kg

Cod. **GR008BI**

Cassetta in ceramica 28.14 h45 cm. con attacco dal basso dx/sx. Peso 13 Kg
Close couple ceramic cistern 28.14 h45 cm. with lower RH/LH water inlet. Weight 13 Kg

Cod. **VA124**

Batteria di scarico con pulsante cromato, attacco posteriore. Ingresso acqua dal basso a destra (Geberit)
Brass chromium-plated discharge mechanism provided with black water inlet lower RH (Geberit)

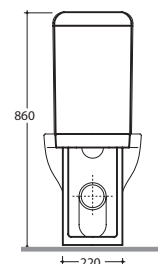

Coprivaso con sistema di cerniere a sgancio rapido
Seat-cover with hinge system to quick release



Trattamento antibatterico per sedili in versione bianco lucido
Antibacterial treatment on toilet seats in shiny white

Cod. **GR021BI**

Coprivaso rimovibile in duroplast con chiusura tradizionale. Peso 2 Kg
Removable duroplast seat-cover with traditional closing system. Weight 2 Kg

Cod. **GR023BI**

Coprivaso rimovibile in duroplast con chiusura rallentata, per GR004BI. Peso 2 Kg
Removable duroplast seat-cover with soft-closing system, for GR004BI. Weight 2 Kg

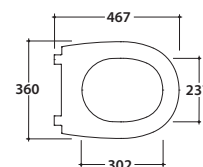
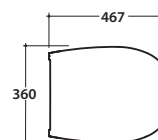

Cod. **VA079**

Curva tecnica per lo scarico a pavimento. Peso 0,3Kg
Elbow pipe for floor drain. Weight 0,3 Kg

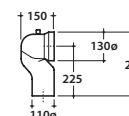

Cod. **VA078**

Raccordo per scarico a pavimento regolabile da 20 a 27 cm. Peso 0,3Kg
Elbow pipe for floor drain. Adjustable 20/27 cm. Weight 0,3 Kg

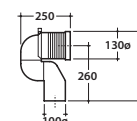

Cod. **VA076**

Raccordo per scarico a parete cm. 35 peso 0,2 Kg
Pipe for wall drain 35cm. Weight 0,2 Kg

