

STONE VASO STS03.BI

GLOBO

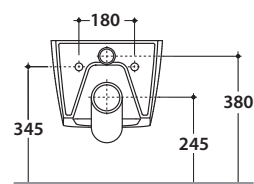
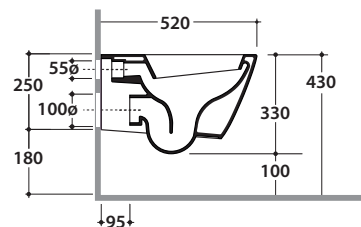
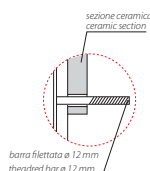
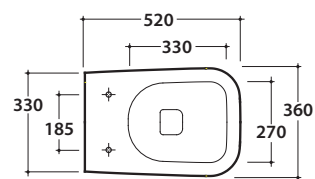

Cod. **STS03.BI**

Vaso sospeso 52.36 cm con sistema di fissaggio dal basso nascosto. Scarico 4,5 / 3 Lt.
Completo di fissaggi. Peso 21 Kg
Wall-hung wc 56236 cm provided with lower hidden fixing system. Drain 4,5 / 3 Lt.
Fixing kit included. Weight 21 kg.



Cod. **ST021BI**

Coprivaso rimovibile in duroplast con chiusura tradizionale. Peso 3 Kg
Removable duroplast seat-cover with traditional closing system. Weight 3 Kg

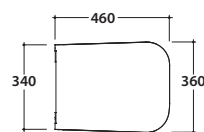

Cod. **ST022BI**

Coprivaso rimovibile in duroplast con chiusura rallentata. Peso 3 Kg
Removable duroplast seat-cover with soft-closing system. Weight 3 Kg



Cod. **FI002**

Staffa di fissaggio a "L". (Barra filettata ø12). Peso 2,5 kg.
Fixing brackets for W/H sanitary. Threaded bar ø 12. Weight 2,5 kg.

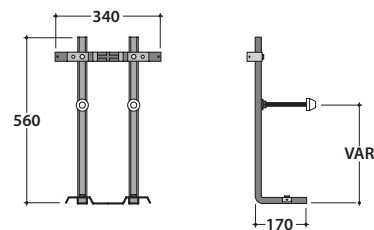

Cod. **VA132**

Riduttore flusso di scarico.
Flow reductor.



Cod. **PU001**

Protezione antiurto e acustica. Peso 0,2 kg.
Acoustic and crash protection. Weight 0,2 kg.